

# PondXpert SpinClean

*Setting up and maintenance of the Spinclean models*



## Spinclean Set Up

This is how your PondXpert Spinclean will look out of the box. You will notice as circled that the "spin" handle is not attached at the moment.

The handle is a push fitment which clicks in to place.



# Hosetails

Inlet hosetail

Outlet  
hosetail

Dirty water hosetail

'O' rings for each  
hosetail

Lid handle

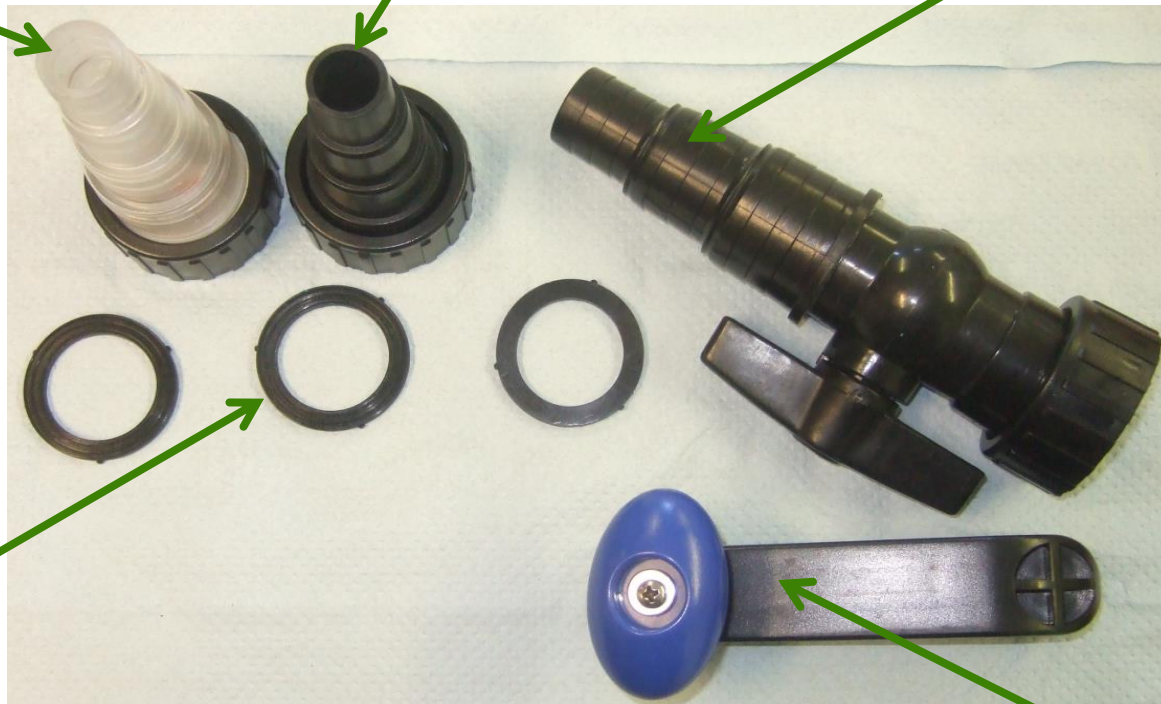

# Hosetails

There are three hosetails supplied for the Spinclean and these are described below. It is important that they are fitted correctly to ensure that the filter will work at its best.

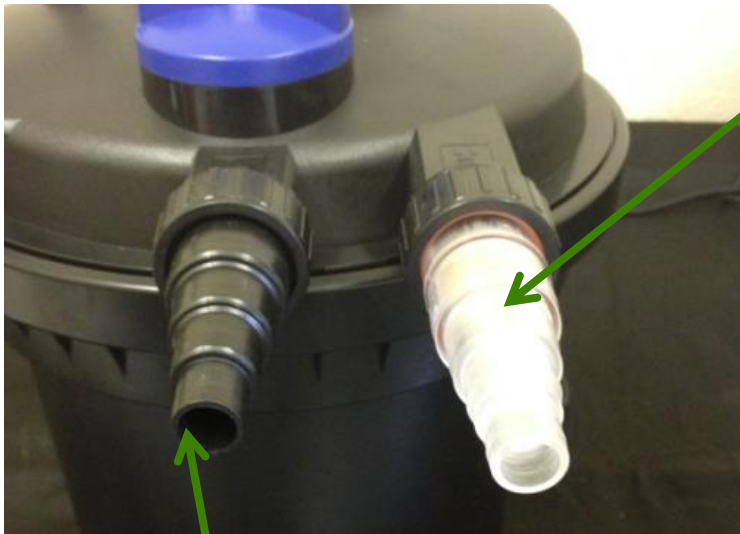

**(1)** The clear hosetail is the inlet valve; this needs to be connected to the hose running from the pond pump.

**(2)** This is the outlet valve which allows cleaned water to return back in to the pond.

The adjustable sludge valve allows water and debris produced during the cleaning function to be diverted away from the filter and the pond.



## Inlet Hosetail

You may notice that there is a small orange mini-impellor in the clear inlet hosetail. This allows you to visibly check that there is a consistently sufficient level of water passing through the hose from the pump.

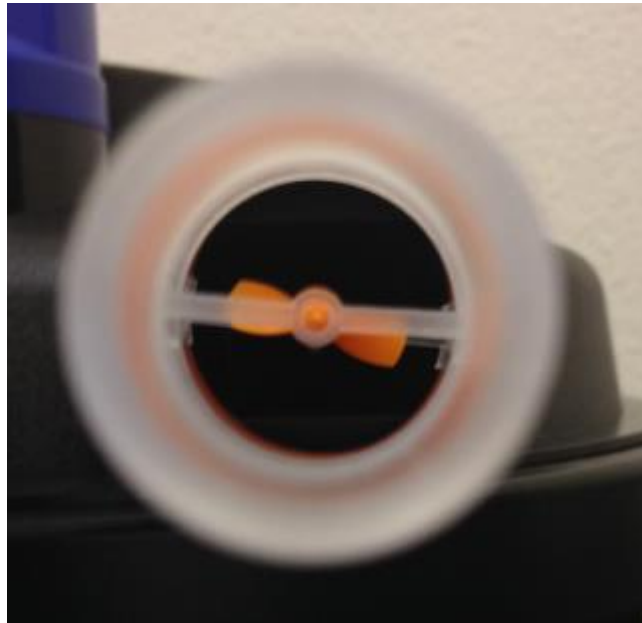

## Spinclean Set Up

The blue switch to the top of the Spinclean allows you to move between the filter's functions. The function is easily selected by turning to the selected function.

In order to use the cleaning function ensure that the blue switch is facing the dirty water pipe; during this process the sludge pipe valve as shown below can be opened to allow any excessive build up to drain also.

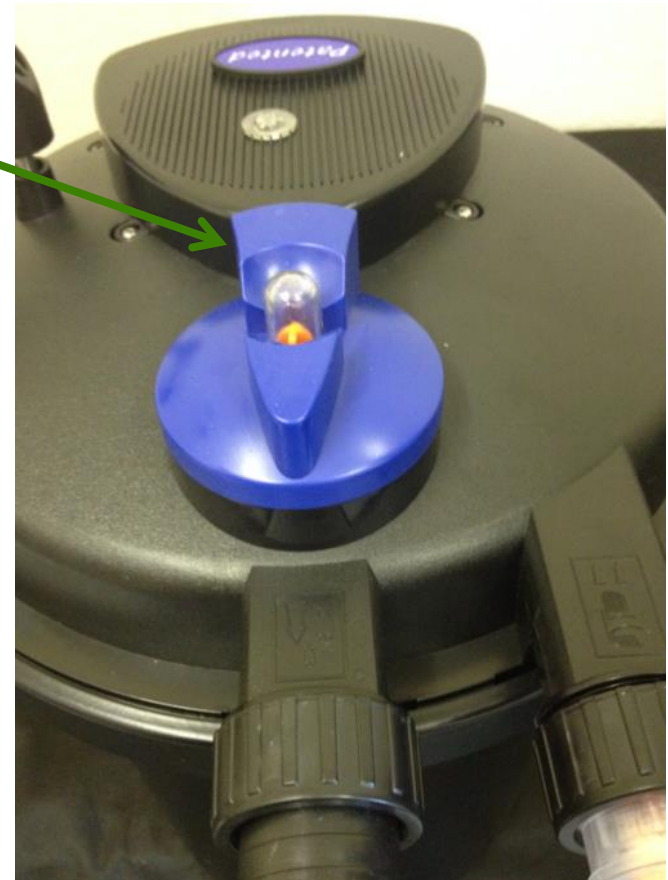

## Accessing the foams

In order to gain access to the filter foams you will need to remove the clamp from the main unit.

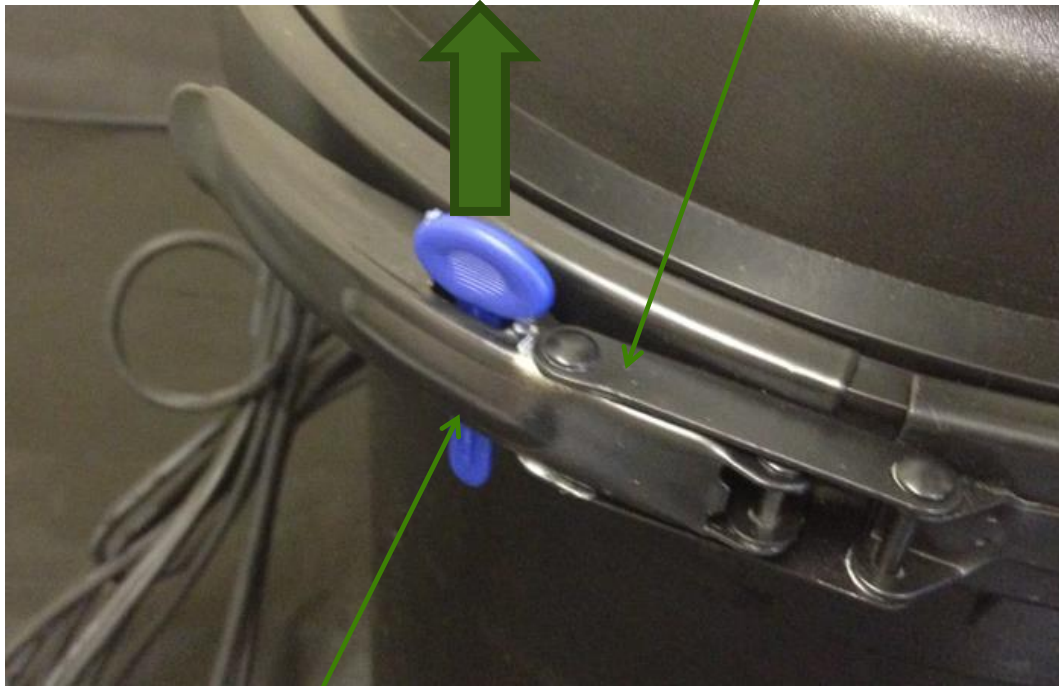

You will firstly need to take out the blue pin shown in the picture above.

## Changing Foams

Once the clamp has been removed the lid should pull away from the base; this may be a little tight to begin with but this is normal.



6000 & 12000 Model- There are three layers of yellow foam and two layers of blue.



20000 Model- There are three layers of yellow foam and two layers of blue.

**In order to dismantle the foams from any of the models you will need to turn the lid upside down.**



## Changing Foams

Once upside down you will need to undo the screw cap at the top and lift.

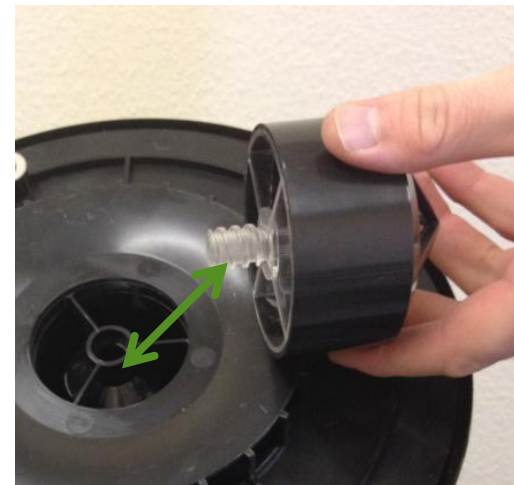

## Changing Foams

There is a screw to the base as circled below; this needs to be removed to release the foams.



The picture above shows the unit without the base plate attached.



## Changing Foams

If required the foams can now be removed, please note that holders can be a little difficult to remove as they are a snug fit; this may also be apparent when replacing with the new foams to the holder.

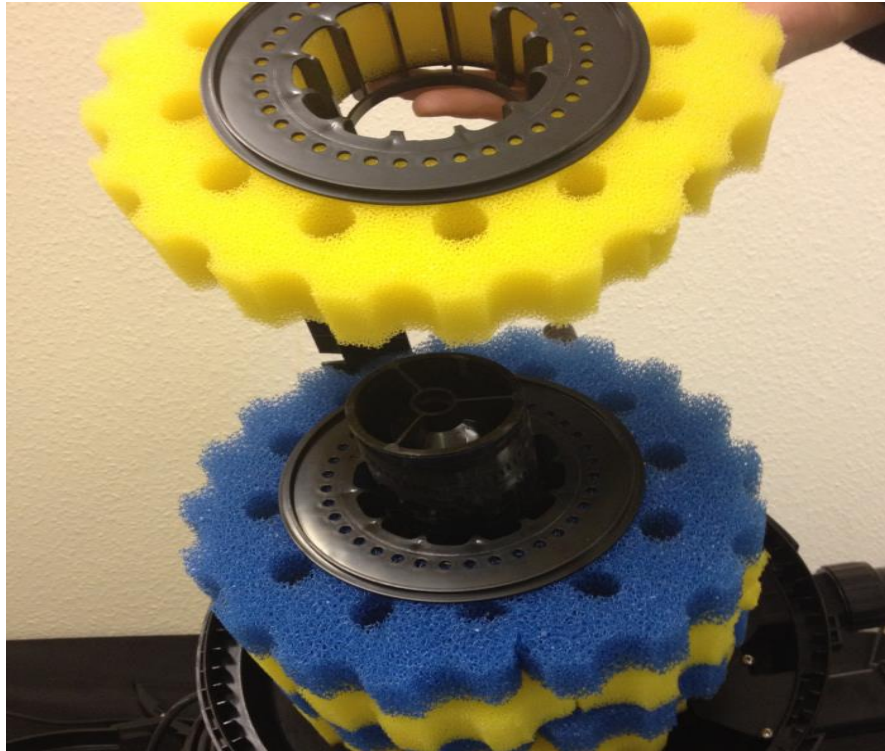

## Accessing the UV Bulb

To access the UVC section the four screws circled will need to be removed.



## Changing UV Bulb

Once the screws have been removed the UV lid will now pop up and lift off. In order to remove the quartz sleeve; remove the screw cap and slide away from the main section.

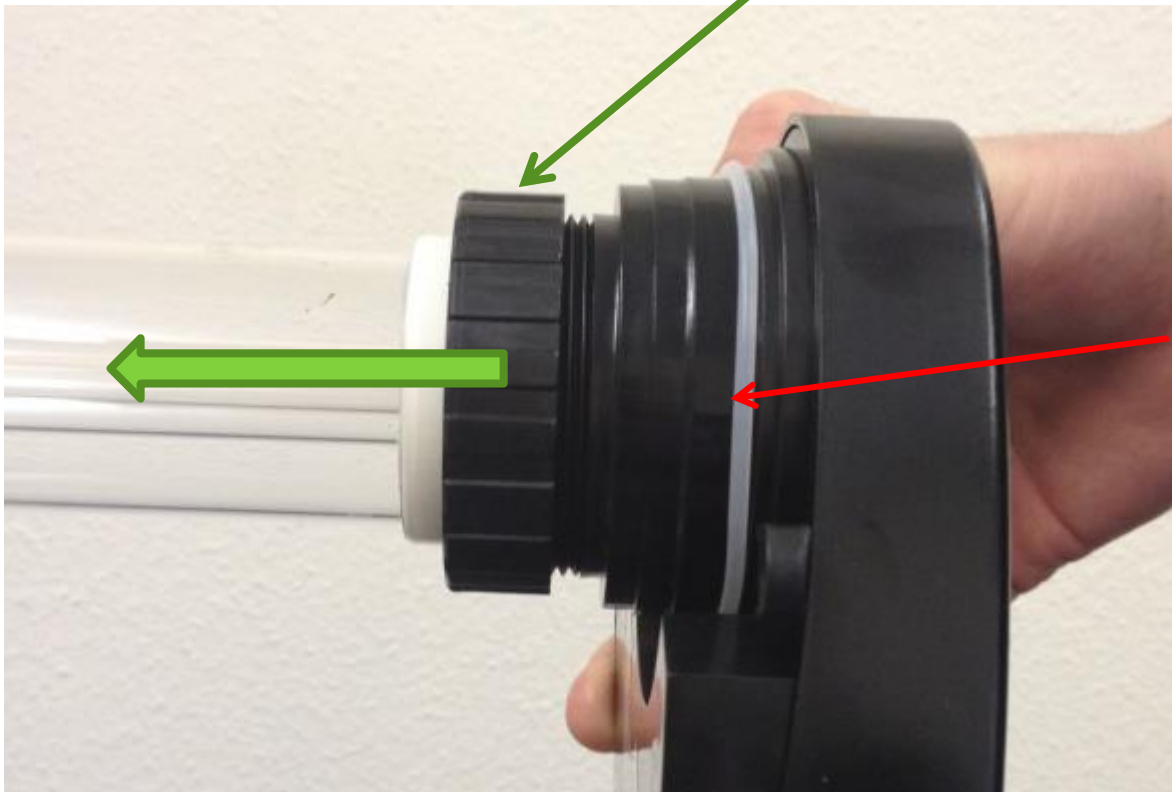

Attention! Please make sure that you do not lose the "O" ring. This is essential in creating a water tight seal to the UV section; preventing the electrical components taking in water.